

## C41

## Water Cooled Resonant Capacitor

### C41-BC5

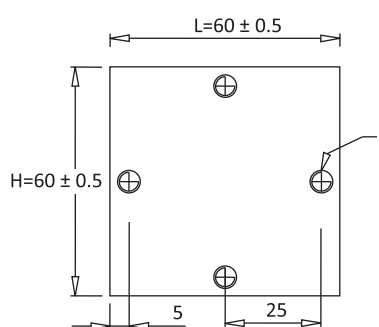
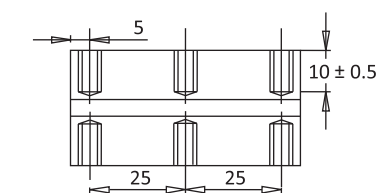

M6 x 1 tap fitted with SS Helicoil (All 4)

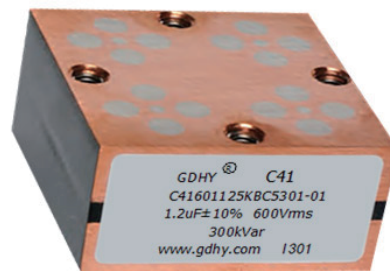
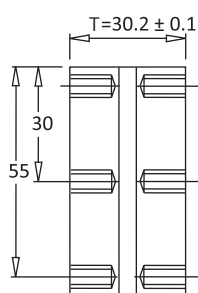

### Article Table

Part Number	Rated Voltage Vrms	Nominal Capacitance $\mu\text{F}$ at 1KHz	Max Irms A	Max Power kVar	Freq Range @Full Power (kHz)	ESR m $\Omega$	Dimension (mm)			Case Code
							L	H	T	
C41102104KBC5301...	1000	0.10	350	300	476-649	1.2	60	60	30.2	BC5
C41102204KBC5301...	1000	0.20	400	300	238-423	1.2	60	60	30.2	BC5
C41701254KBC5301...	700	0.25	500	300	390-530	1.2	60	60	30.2	BC5
C41701334KBC5301...	700	0.33	500	300	295-401	1.0	60	60	30.2	BC5
C41701664KBC5301...	700	0.66	500	300	147-200	0.8	60	60	30.2	BC5
C41601105KBC5301...	600	1.00	650	300	132-223	0.5	60	60	30.2	BC5
C41601125KBC5301...	600	1.20	650	300	111-187	0.5	60	60	30.2	BC5
C41601135KBC5301...	600	1.30	650	300	100-170	0.3	60	60	30.2	BC5
C41501245KBC5301...	500	2.40	650	300	80-97	0.2	60	60	30.2	BC5
C41501265KBC5301...	500	2.60	650	300	72-85	0.2	60	60	30.2	BC5
C41401505KBC5301...	400	5.00	800	300	59-67	0.1	60	60	30.2	BC5
C41102334KBC5401...	1000	0.33	600	400	194-433	1.0	60	60	30.2	BC5
C41102664KBC5401...	1000	0.66	600	400	95-216	0.8	60	60	30.2	BC5
C41901125KBC5401...	900	1.20	850	400	58-215	0.3	60	60	30.2	BC5
C41801135KBC5401...	900	1.30	850	400	58-215	0.3	60	60	30.2	BC5
C41701265KBC5401...	700	2.60	950	400	51-138	0.2	60	60	30.2	BC5
C41501505KBC5401...	500	5.00	1000	400	50-80	0.1	60	60	30.2	BC5

The above table / graphics are for reference only, subject to the actual product (unit: mm)

## C41

## Water Cooled Resonant Capacitor

### Temperature Characteristics

—●— Voltage    —■— Current    —▲— Power

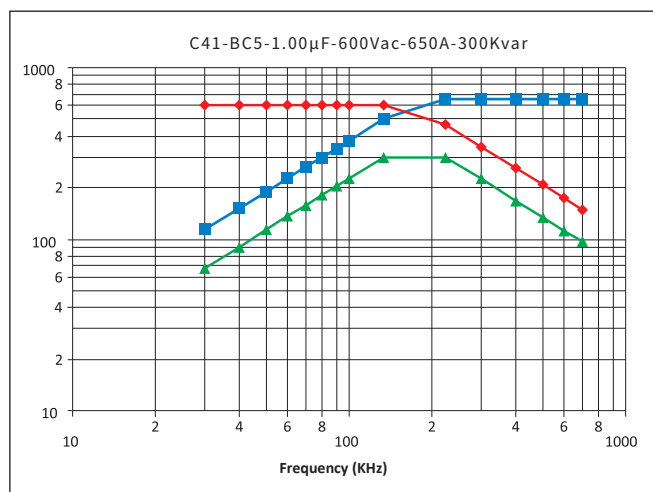
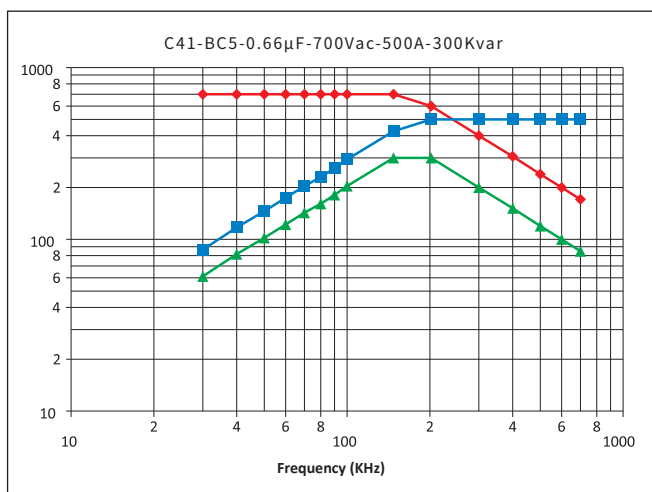
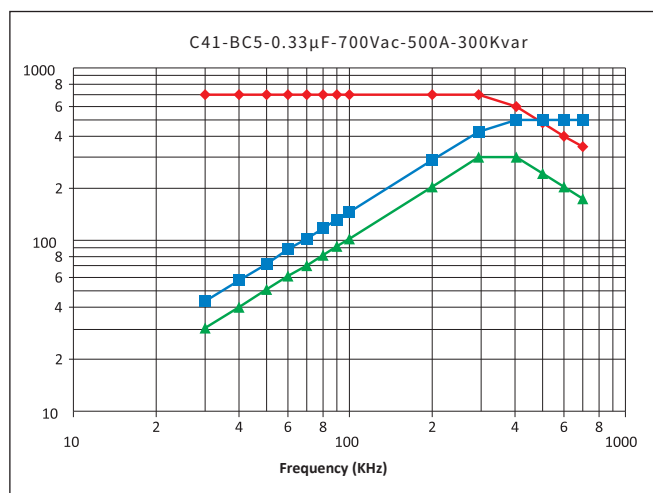
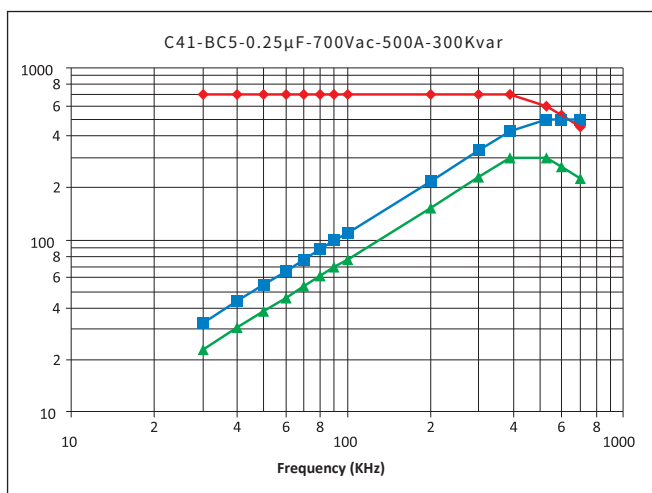
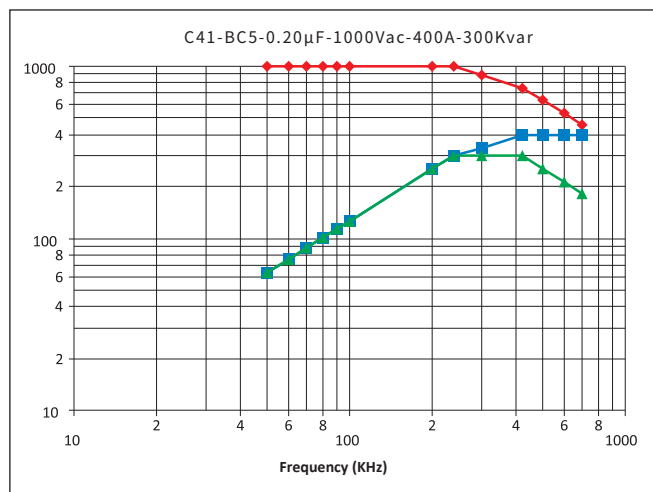
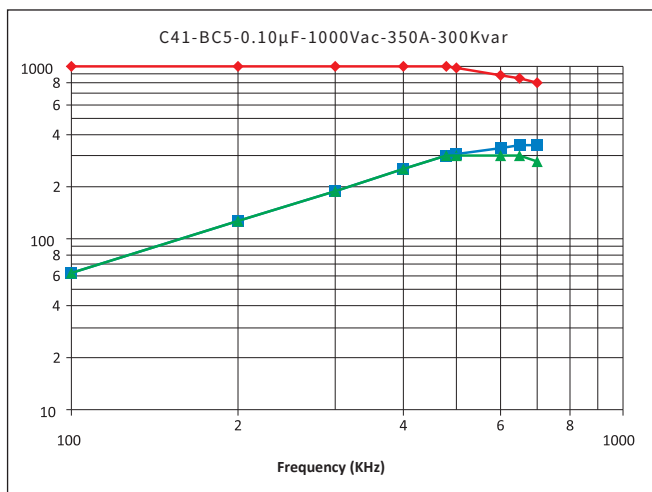

## C41

## Water Cooled Resonant Capacitor

### Temperature Characteristics

—●— Voltage    —■— Current    —▲— Power

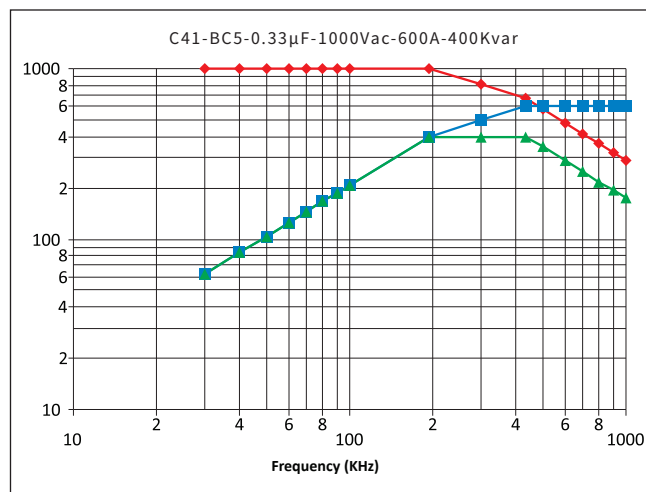
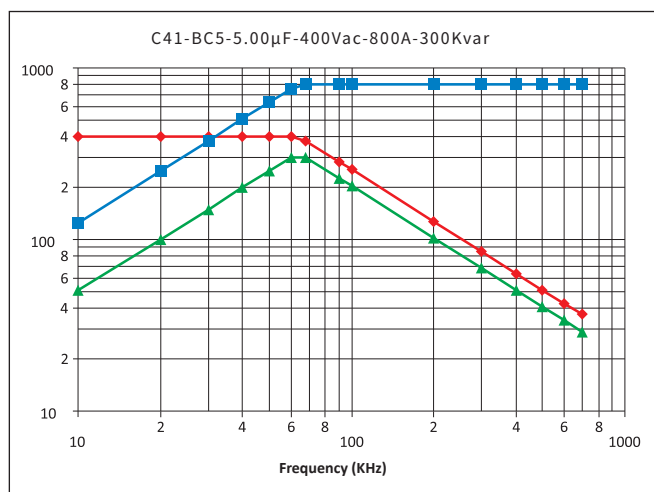
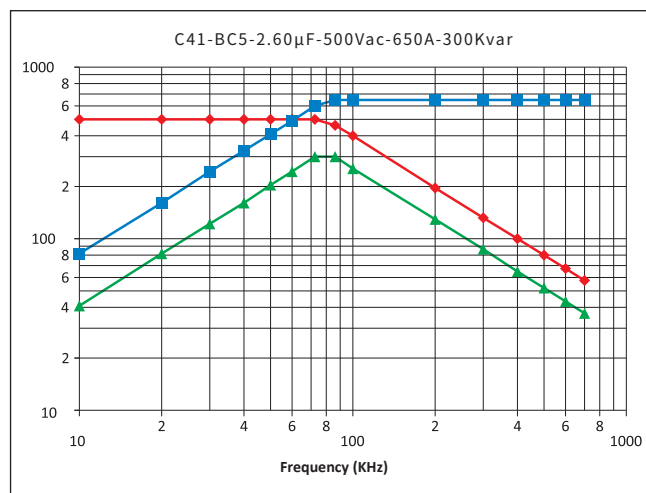
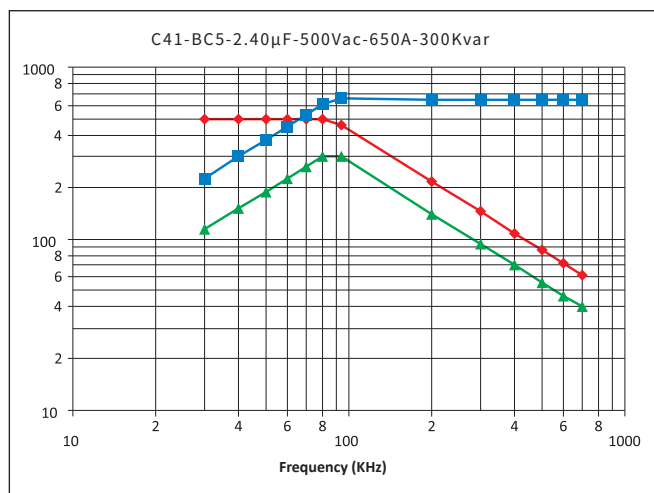
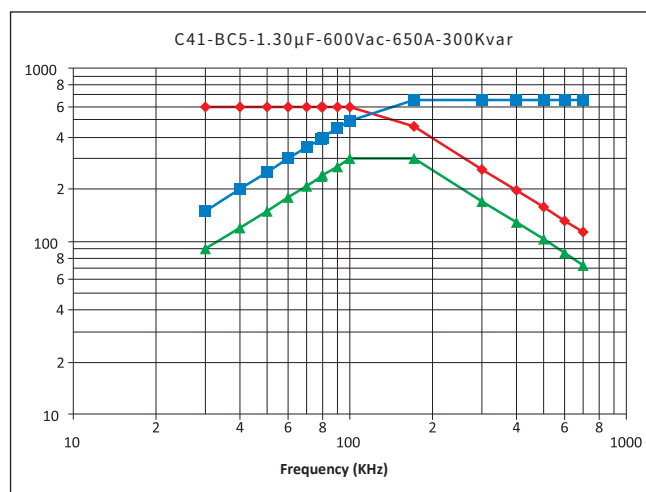
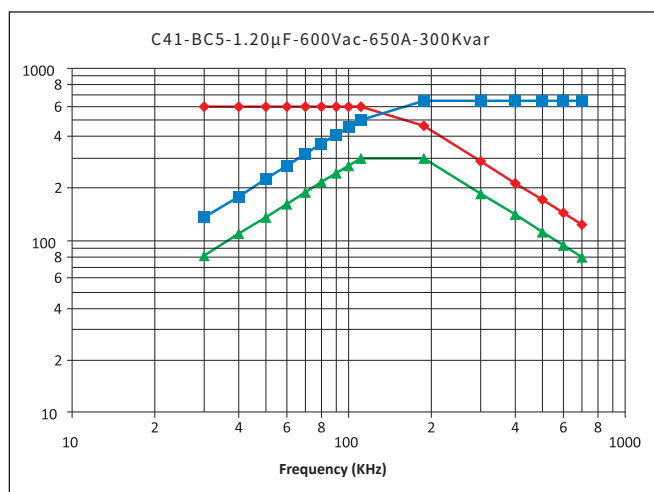

## C41

## Water Cooled Resonant Capacitor

### Temperature Characteristics

—●— Voltage    —■— Current    —▲— Power

